

SNAKE LOFTY

Flow: 2000 GPM @ 100 PSI - 7500 l/mn @ 7 bars
 Horizontal Range: +180° to -180°
 Vertical Range: +90° to -90°
 Extremely Compact 29" X 25"
 Vertical and Horizontal Travel Control Wheel Handles
 Grease Fitting
 Waterway 3.5" with Anti -Turbulence Ribbing
 Red Epoxy Finish
 Made Primarily of Anodized Aluminum Heat-Treated against Corrosion,
 Marine Environment and Foam
 Flange or 4.0" inlet 3.5" outlet

Code	Description	Weight
18340	SNAKE LOFTY flange inlet and 3.5" M outlet	81.57 lb

MINOTOR 5000

Flow: 1350 GPM @ 100 PSI - 5000 l/mn @ 7 bars
 Horizontal Range: Full 360°
 Vertical Range: +75° to 0°
 Extremely Compact 28" X 15"
 Vertical Travel Control Wheel Handle with Safety Pull Pin
 Grease Fitting and Gauge
 Waterway 3.5" with Anti -Turbulence Ribbing
 Red Epoxy Finish
 Made Primarily of Anodized Aluminum Heat-Treated against Corrosion,
 Marine Environment and Foam
 Flange inlet 4.0" outlet

Code	Description	Weight
13610	MINOTOR flange inlet and 4.0" M outlet	59.52 lb

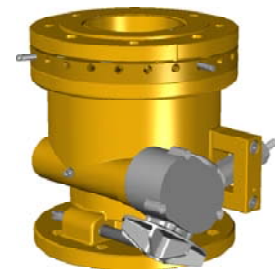

Hydraulic Actuator



Hydrant Mount



TRIPOD Stand



Electric Telescopic Tube

Code	Description
0460	Oscillator made in Bronze and Stainless Steel can be adjusted between 20° and 360°, specify flanges
8925	Hydrant mount in steel finish red epoxy with mount, specify flanges
9527	TRIPOD in steel finish red epoxy no valve, specify flanges
9533	TRIPOD in steel finish red epoxy with valves, specify flanges
21151	Electric Telescopic Tube 20 " 3.0" inlet and specify inlet flange